



**Parks**

# QueensWay Metropolitan Hub

Located between Trotting Course Lane, Metropolitan Expeditionary Learning School Driveway, Metropolitan Ave and Union Turnpike in the Borough of Queens.

Community Board 6 Meeting  
December 17, 2024  
Techno + Sasaki, EDC, NYC Parks

**Total Budget:** \$46M  
New York City Council - \$2.5M FY22  
Mayor, Eric Adams - \$32.5M FY22  
USDOT, RCN/NAE Grant - \$11M (expected)

**Project Size:** 5.24 ac

# Agenda

- Project Context
- Community Input Meeting Overview
- Preliminary Design
- Timeline Overview



# Goals

- New neighborhood linear park
- Active and passive recreation
- Greenway/Bikeway connections
- Pedestrian pathways
- Engagement with adjacent facilities
- Restoration and enhancement of natural areas
- Provide ADA accessibility into and throughout the site



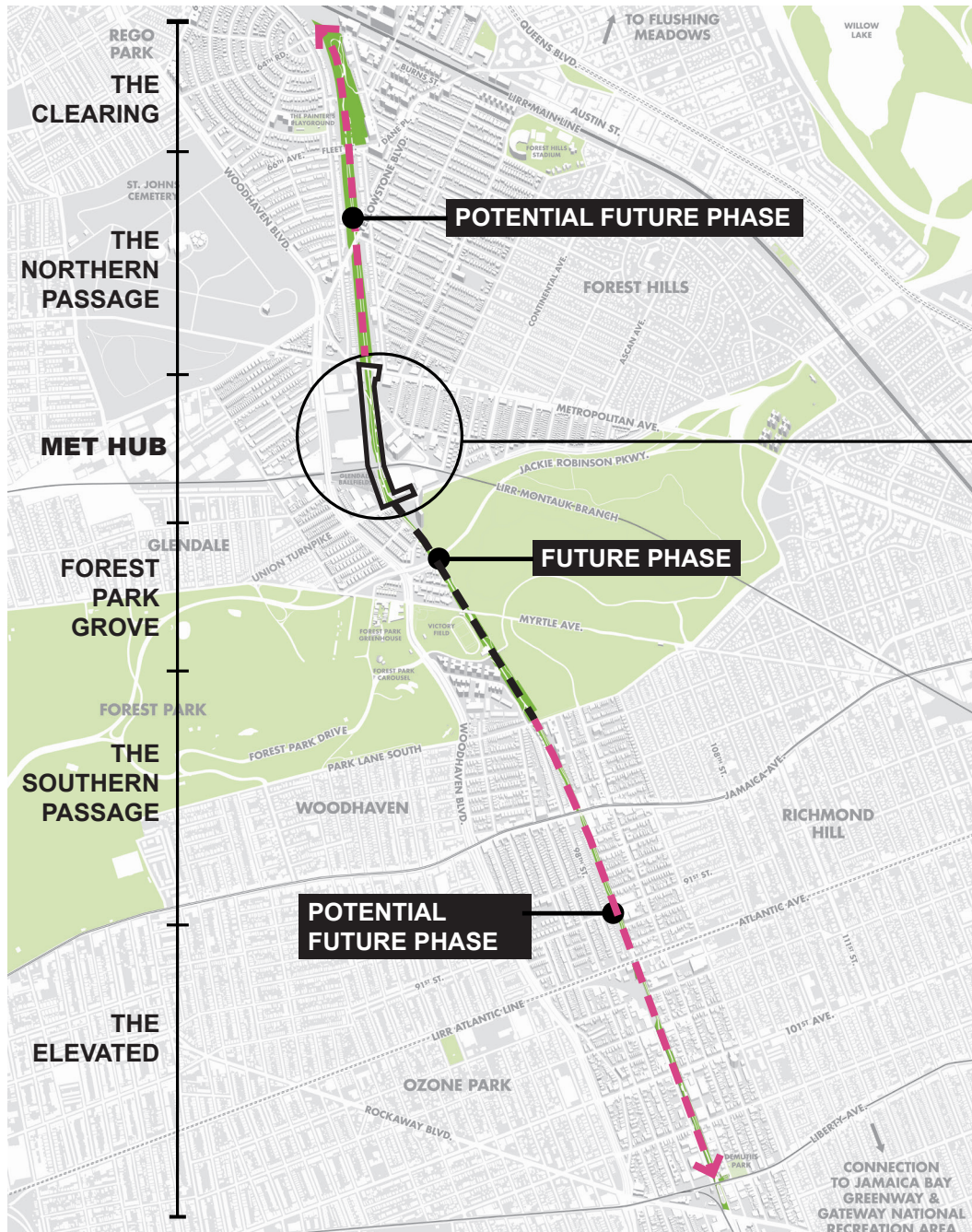

QueensWay Plan

1000 FT

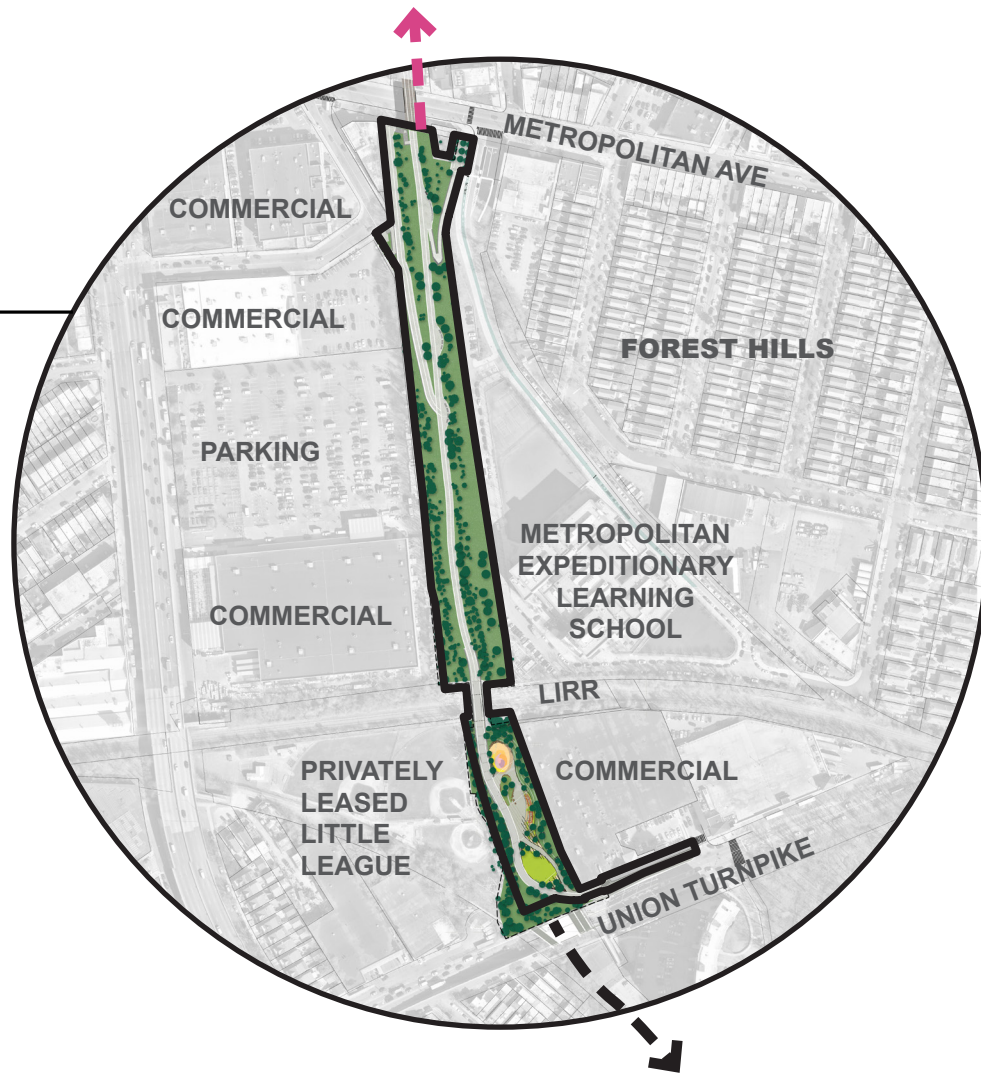

Metropolitan Hub Site

500 FT

### Legend

- Met Hub Project Limit
- Future Phase of the QueensWay
- Potential Future Phases of the QueensWay

### Project Context: QueensWay Conceptual Plan

The QueensWay will transform a 3.5 mile length of the abandoned Rockaway Beach Branch LIRR line into a new public space corridor that will connect 6 neighborhoods.

The Metropolitan Hub (Met Hub) is the first phase of the larger QueensWay that will set the precedent for future phases. It is a 1/3 mile segment located north of Forest Park and adjacent to the Metropolitan Expeditionary Learning School complex (MELS). This segment will include a shared use greenway, pedestrian paths, program and seating areas, and improved understory planting.



NYC Parks



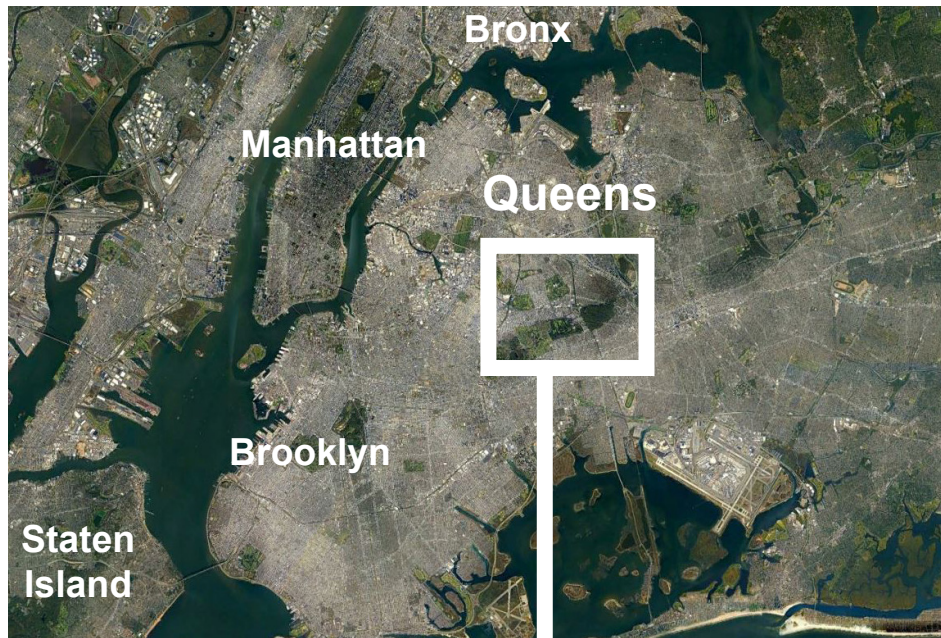

City

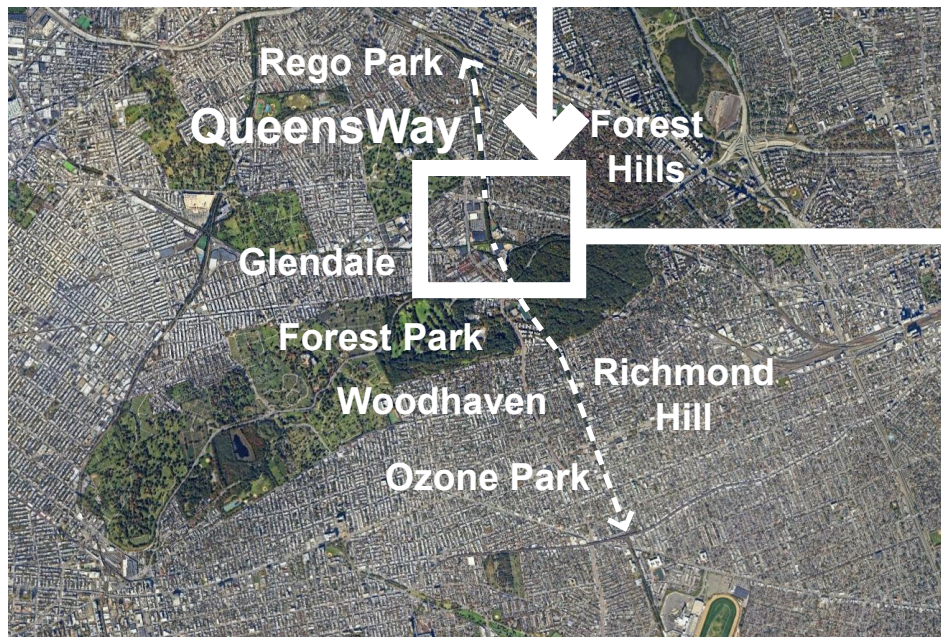

Neighborhood



Site



NYC Parks



# QueensWay: Metropolitan Hub | Project Location



# Community Input Meeting (12/19/23)

Which of the following activities would you MOST like to do in this park?

Total Zoom Participation: **82**

Poll Responses: **62**

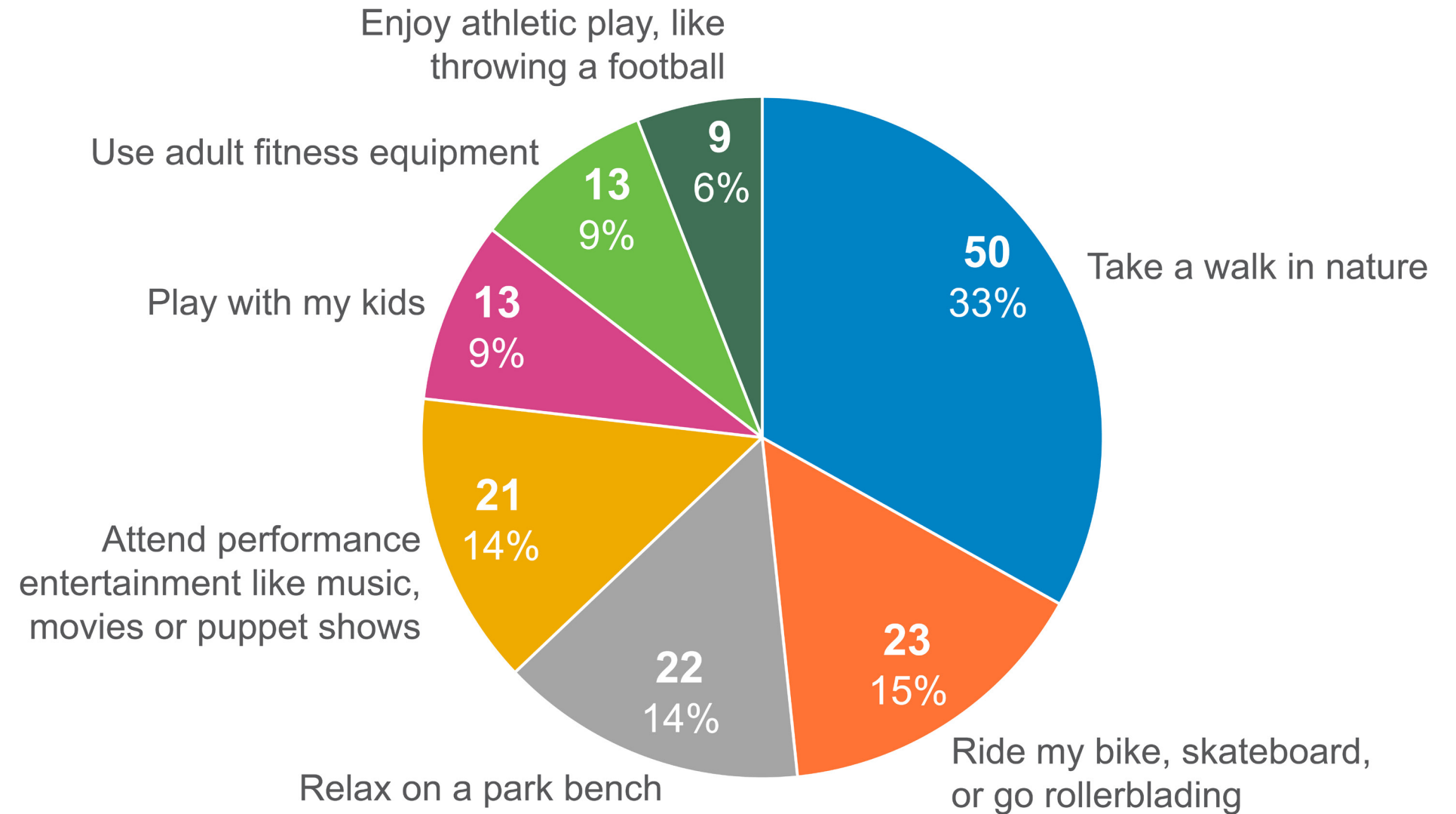

**NYC / EDC**

QueensWay: Metropolitan Hub | Community Input Meeting

# Community Input Meeting (12/19/23)

## Community Priorities for Program Areas

### Play and Recreation:

- Open spaces and flexible areas for children to run, play, and enjoy the scenery.
- Playgrounds, tables for playing games.
- Safe and accessible space for children to engage in active play.

### Cycling and Fitness:

- Safe, dedicated bike lanes, bike pumps and repair stations to encourage cycling. Clear wayfinding.
- Space for yoga and wellness programming.

### Art and Culture:

- Art installations, street art, murals, sculptures, and rotating art exhibits.
- Spaces for live music performances and community events.

### Nature and Sustainability:

- Green spaces, native plant species, and sustainable design elements.
- Community garden, composting facilities, and educational signage about local flora and fauna.

### Community Gathering Spaces:

- Creating welcoming and inviting spaces for community members to gather, socialize, and relax.
- Picnic tables, seating areas, and covered walkways/shelters for protection from the sun and rain.

### Accessibility and Connectivity:

- Provide accessible pathways, ramps, and entrances to ensure the park is inclusive and welcoming to people of all abilities.
- Connections to public transportation and nearby amenities to encourage park usage, in addition to clear wayfinding.



# Community Input Meeting (1/8/24)

Which of the following activities would you MOST like to do in this park?

Total Zoom Participation: **87**

Poll Responses: **47**

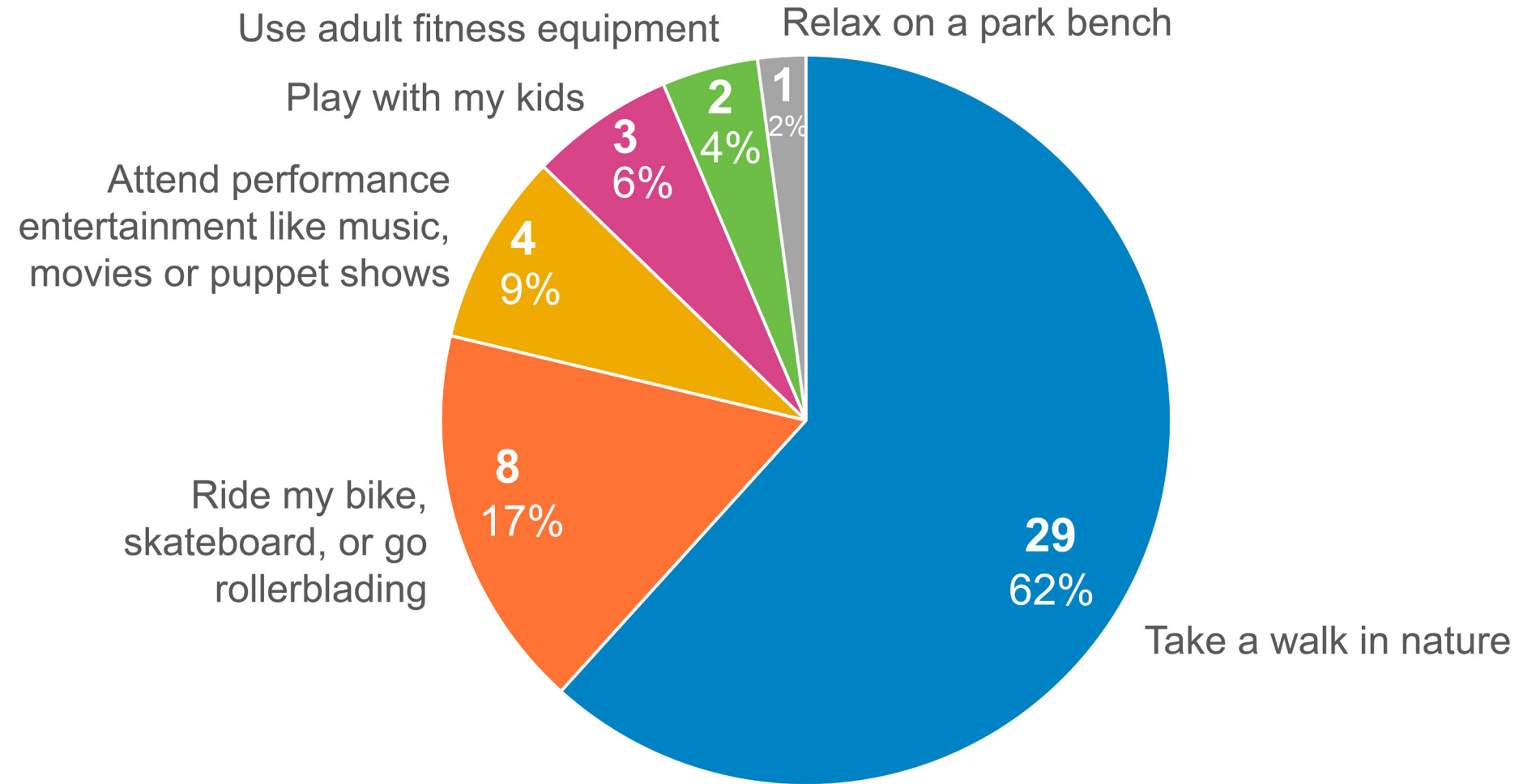

**NYC / EDC**

QueensWay: Metropolitan Hub | Community Input Meeting



# Community Input Meeting (1/8/24)

## Community Priorities for Program Areas

### Play and Recreation:

- Designate a flexible area for outdoor fitness/sports, music, and kids' programs.
- Formal children's playground not a priority due to proximity to DeVoy Playground.

### Cycling and Fitness:

- Outdoor fitness, adult fitness equipment, outdoor fitness circuit
- Bike connection to Forest Park is important
- Safe bike parking

### Art and Culture:

- Host community and cultural events, connect with local businesses and promote local artists.
- Consider live performances.

### Nature and Sustainability:

- Preserve existing trees, add native trees to support birds.
- Community gardens where residents can have plots to grow flowers or vegetables.
- Plant trees and other vegetation to enhance the natural beauty of the park.

- Desire for low maintenance (simple) planting and quality materials
- Explore the feasibility of incorporating solar or wind power for sustainable energy.

### Community Gathering Spaces:

- Create flexible spaces for outdoor classes and performances. Provide seating and shade in these areas.
- Create green spaces with benches and picnic tables for relaxation and casual gatherings under trees.

### Accessibility and Connectivity:

- Provide adequate lighting and security measures for safety.
- Safe connection between Union Turnpike and Metropolitan Avenue
- Connections to commercial space, businesses, and neighborhood
- Provide water fountains.
- Provide public restrooms.



# Overall Vision

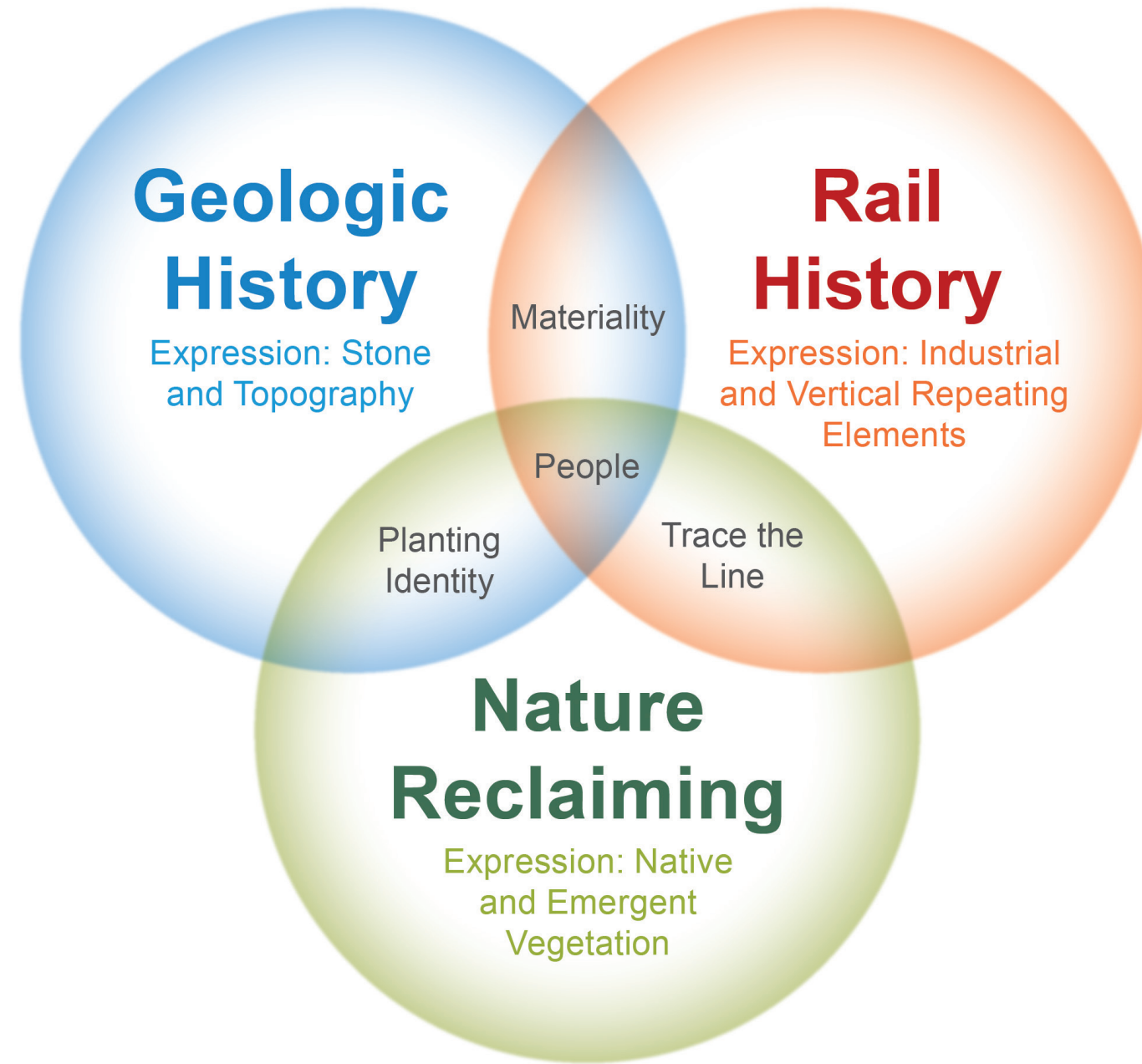

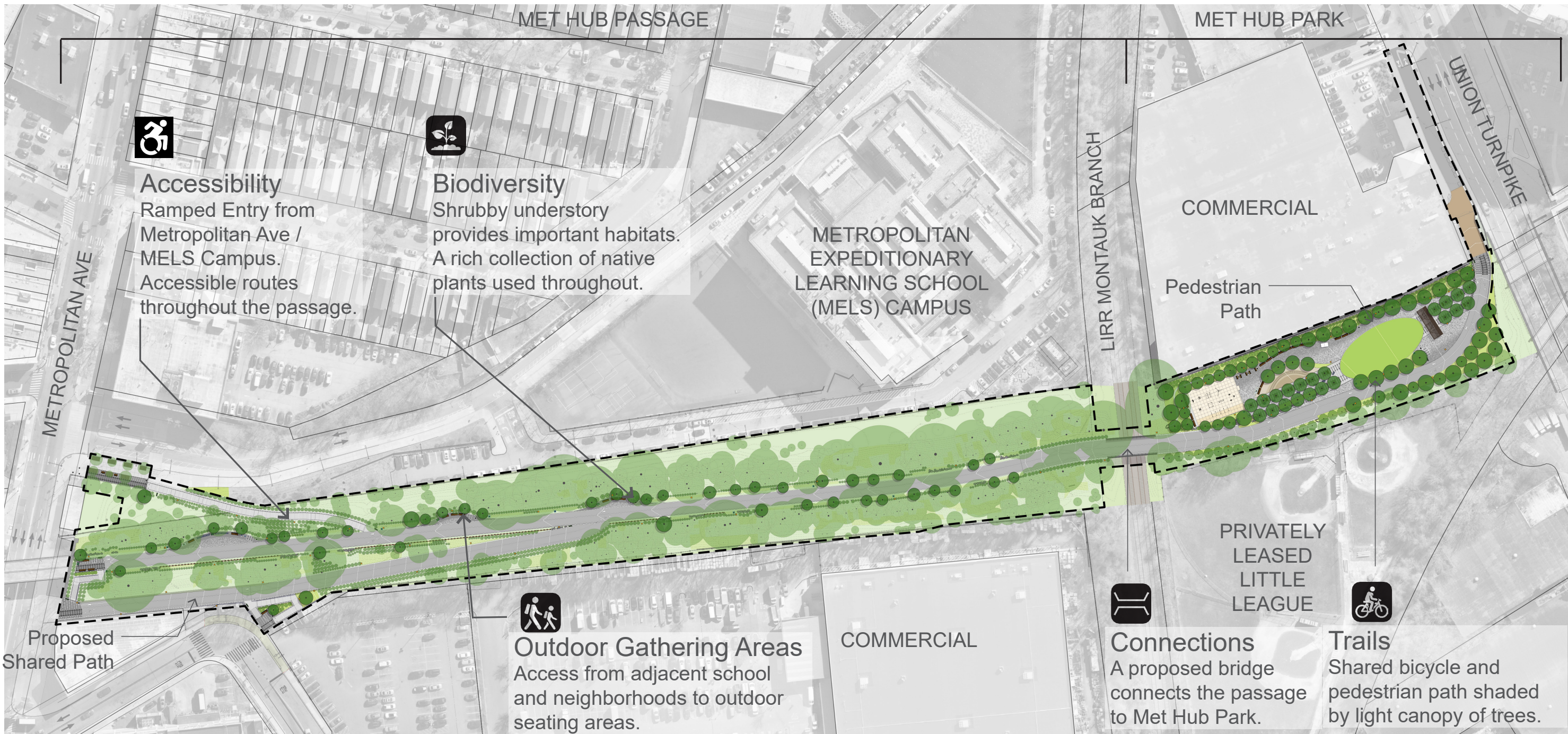



### Legend

- Hexagonal Unit Paver
- Rectangular Unit Paver
- Existing Planting
- Proposed Planting
- Tree Pit (Mulch)
- Existing Tree
- Proposed Tree
- Proposed Shrub
- Natural Boulder
- Fence/Guardrail
- Fence Gate
- Removable Bollards
- Project Limit
- Game Table and Bench
- Ping Pong Table
- Bottle Filler
- Bike Rack
- Signage
- Ground Hydrant
- Trash Receptacle

- Asphalt
- Concrete
- Light Pole
- Bench w/ Armrests
- Rectangular Boulder Seating
- Rectangular Boulder Seating w/ Armrests
- Bike Repair Station



**NYC / EDC**

QueensWay: Metropolitan Hub | Preliminary Plan (1 of 4)

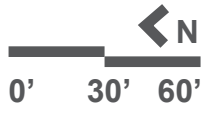

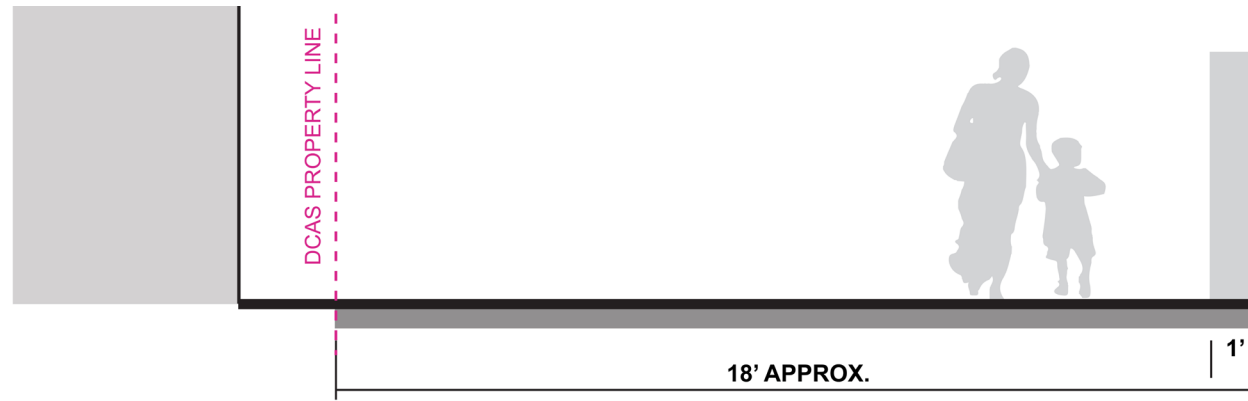

EXISTING

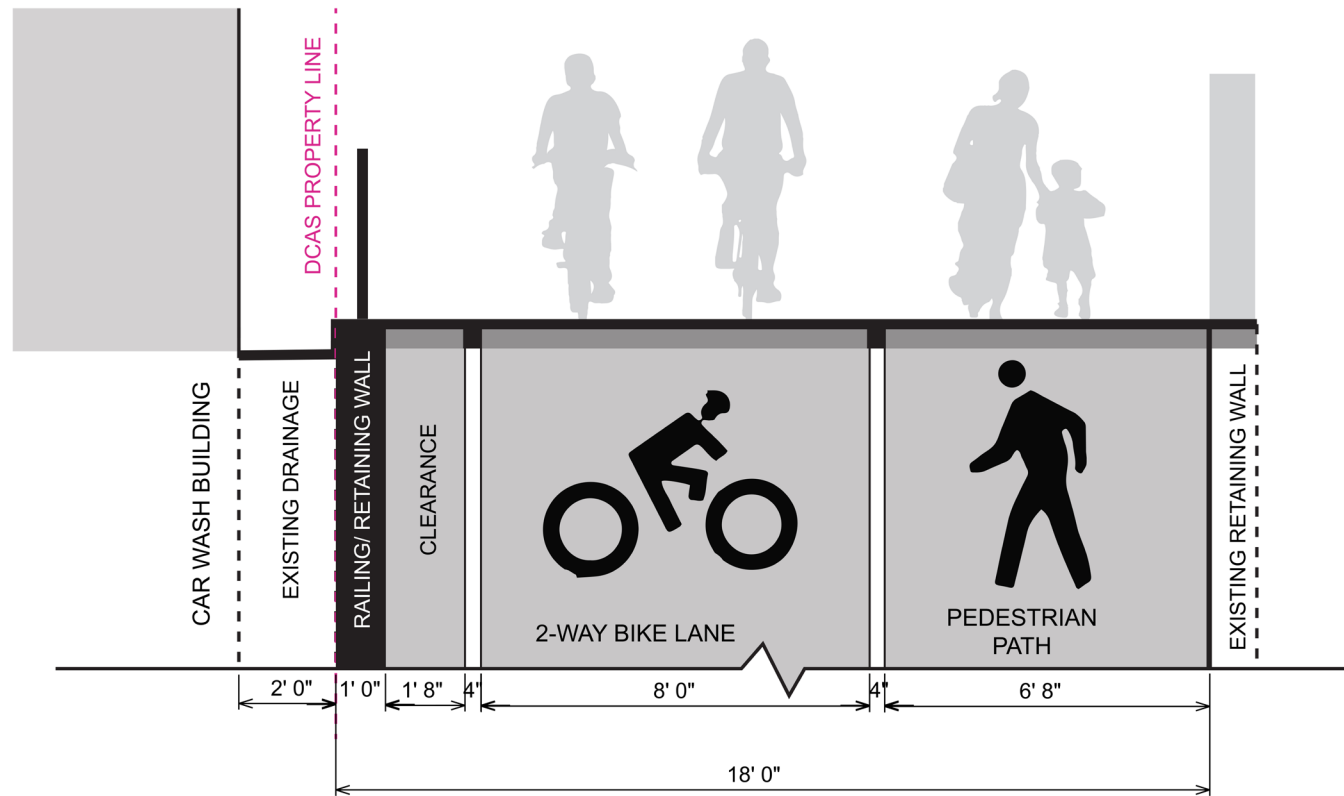

PROPOSED



**NYC / EDC**

QueensWay: Metropolitan Hub | Shared Path at Metropolitan Ave Section

Not To Scale

Approved Per PDC Conceptual Submission 13

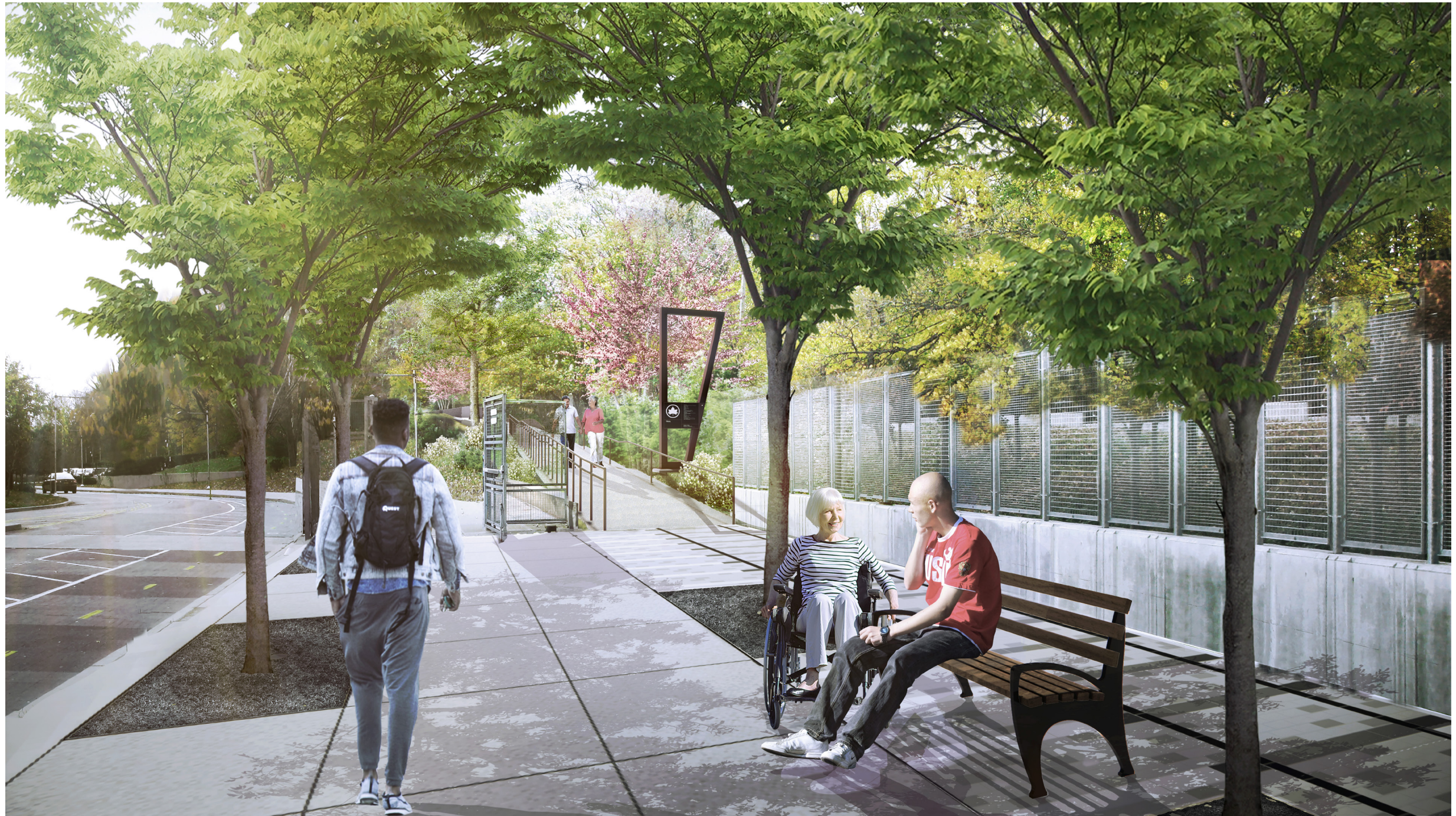

**NYC / EDC**

**QueensWay: Metropolitan Hub | Perspective View - Metropolitan Avenue MELS Entrance**



### Legend

- |  |   |  |                        |
|--|---|--|------------------------|
|  | Asphalt                                 |  | Hexagonal Unit Paver   |
|  | Concrete                                |  | Rectangular Unit Paver |
|  | Light Pole                              |  | Existing Planting      |
|  | Bench w/ Armrests                       |  | Proposed Planting      |
|  | Rectangular Boulder Seating             |  | Tree Pit (Mulch)       |
|  | Rectangular Boulder Seating w/ Armrests |  | Existing Tree          |
|  | Game Table and Bench                    |  | Proposed Tree          |
|  | Ping Pong Table                         |  | Proposed Shrub         |
|  | Bottle Filler                           |  | Natural Boulder        |
|  | Bike Rack                               |  | Fence/Guardrail        |
|  | Signage                                 |  | Fence Gate             |
|  | Ground Hydrant                          |  | Removable Bollards     |
|  | Trash Receptacle                        |  | Project Limit          |
|  | Bike Repair Station                     |  |                        |



**NYC / EDC**

QueensWay: Metropolitan Hub | Preliminary Plan (2 of 4)

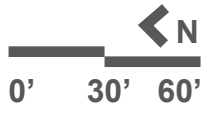

# Shared Use Path

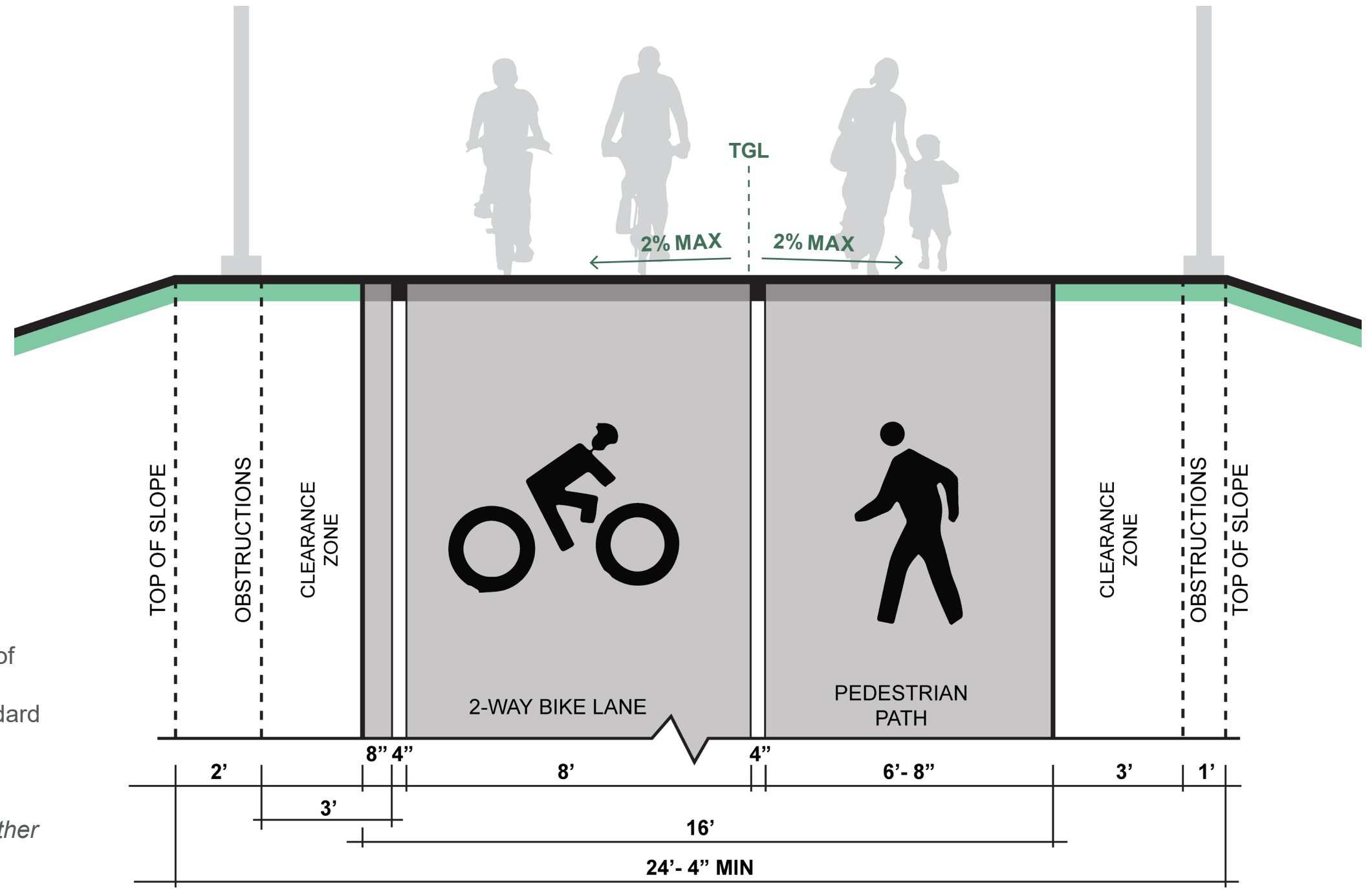

## Shared Use Path Width

Conforms to AASHTO Guide for the Development of Bike Facilities Clearance Requirements, 2012  
 Meets minimum requirements for NYC Parks Standard Detail, 2020: Greenway Pavement Markings\*

\*Pedestrian path was increased from 4' to 6'-8" to allow people to more comfortably pass one another



**NYC / EDC**

QueensWay: Metropolitan Hub | Typical Shared Use Path Section

Not To Scale

Approved Per PDC Conceptual Submission 16



COMMERCIAL

METROPOLITAN EXPEDITIONARY LEARNING SCHOOL (MELS) CAMPUS

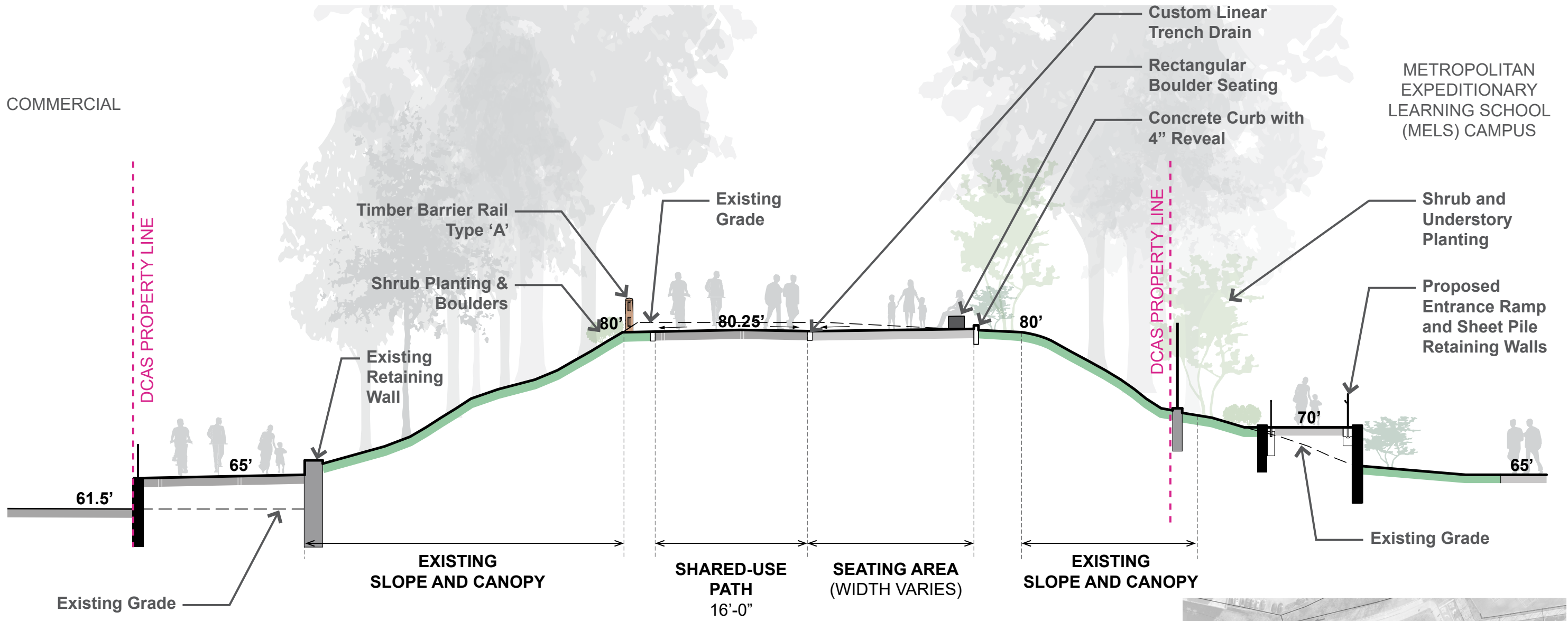

0' 5' 10' 20'



NYC / EDC

QueensWay: Metropolitan Hub | Shared Path at Seating Area Section



**NYC / EDC**

**QueensWay: Metropolitan Hub | Perspective View - Typical Shared Path On Embankment**

MATCH LINE C-C



### Legend

- |  |   |  |                        |
|--|---|--|------------------------|
|  | Asphalt                                 |  | Hexagonal Unit Paver   |
|  | Concrete                                |  | Rectangular Unit Paver |
|  | Light Pole                              |  | Epoxy Coating          |
|  | Bench w/ Armrests                       |  | Existing Planting      |
|  | Rectangular Boulder Seating             |  | Proposed Planting      |
|  | Rectangular Boulder Seating w/ Armrests |  | Tree Pit (Mulch)       |
|  | Game Table and Bench                    |  | Existing Tree          |
|  | Ping Pong Table                         |  | Proposed Tree          |
|  | Bottle Filler                           |  | Proposed Shrub         |
|  | Bike Rack                               |  | Natural Boulder        |
|  | Signage                                 |  | Fence/Guardrail        |
|  | Ground Hydrant                          |  | Fence Gate             |
|  | Trash Receptacle                        |  | Removable Bollards     |
|  | Bike Repair Station                     |  | Project Limit          |



**NYC / EDC**

QueensWay: Metropolitan Hub | Preliminary Plan (3 of 4)

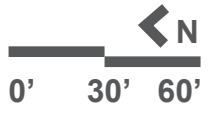



NYCDOT Standard Curved Fence with Railing

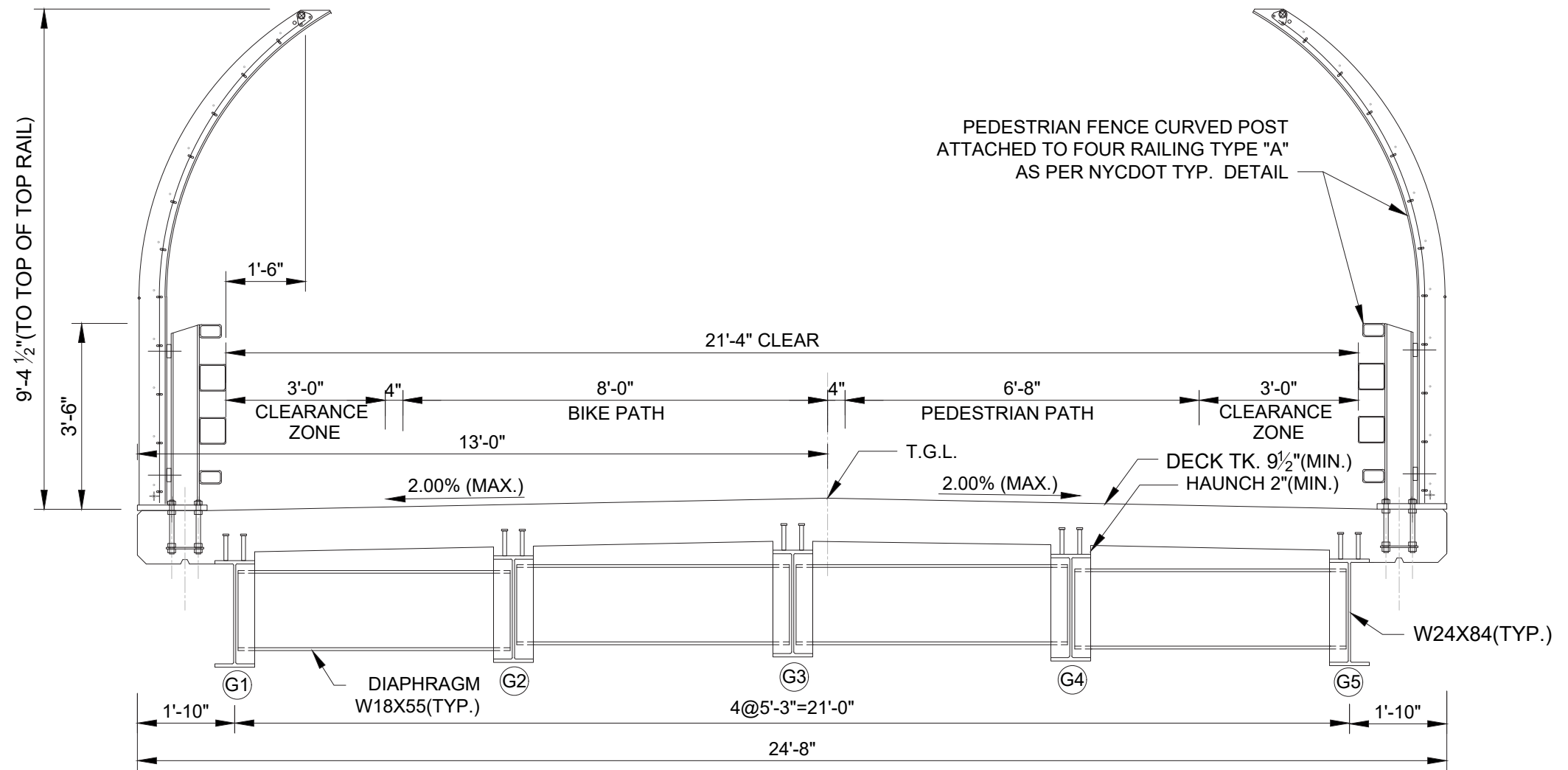

**NYC / EDC**

QueensWay: Metropolitan Hub | Proposed Bridge Section



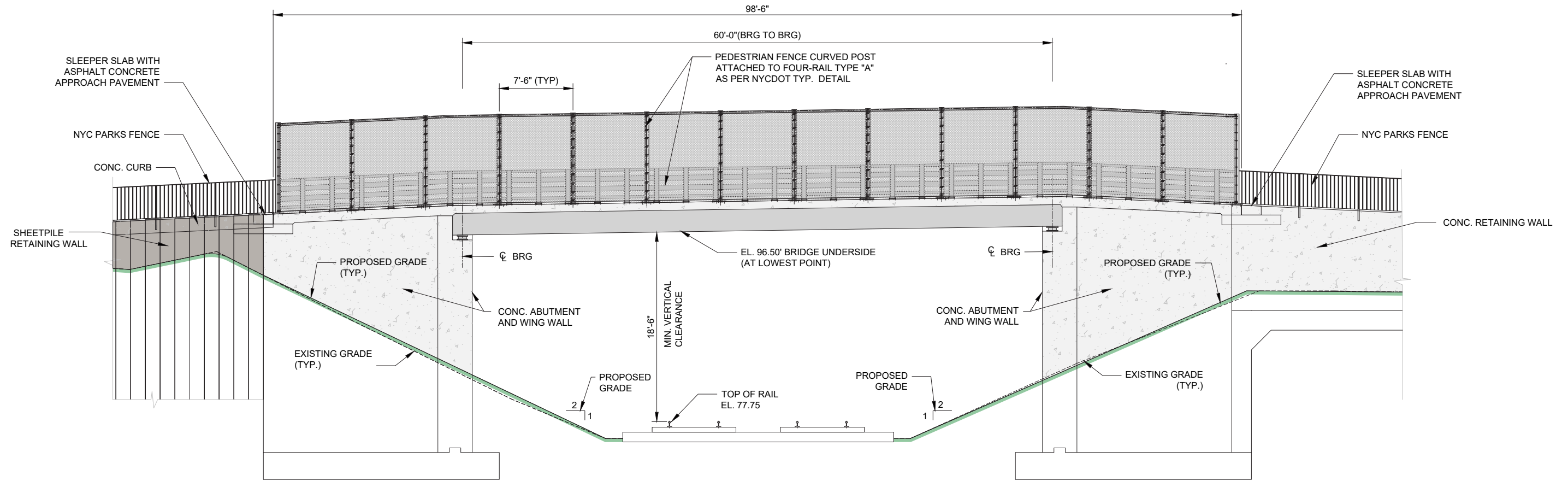

**NYC / EDC**

QueensWay: Metropolitan Hub | Proposed Bridge Elevation

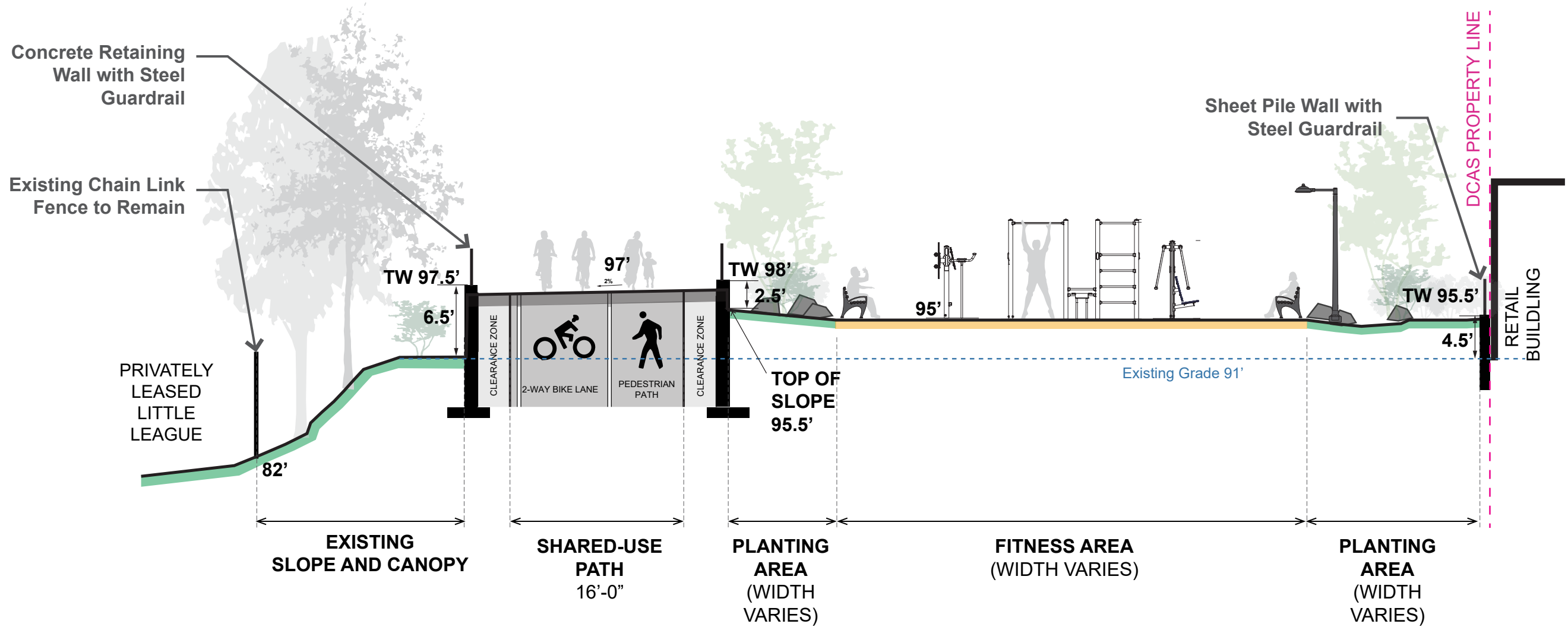

**NYC / EDC**

QueensWay: Metropolitan Hub | Shared Path at Program Area Section



**NYC / EDC**

**QueensWay: Metropolitan Hub | Perspective View - Adult Fitness Area**



### Legend

- |  |   |  |                        |
|--|---|--|------------------------|
|  | Asphalt                                 |  | Hexagonal Unit Paver   |
|  | Concrete                                |  | Rectangular Unit Paver |
|  | Light Pole                              |  | Epoxy Coating          |
|  | Bench w/ Armrests                       |  | Existing Planting      |
|  | Rectangular Boulder Seating             |  | Proposed Planting      |
|  | Rectangular Boulder Seating w/ Armrests |  | Tree Pit (Mulch)       |
|  | Game Table and Bench                    |  | Existing Tree          |
|  | Ping Pong Table                         |  | Proposed Tree          |
|  | Bottle Filler                           |  | Proposed Shrub         |
|  | Bike Rack                               |  | Natural Boulder        |
|  | Signage                                 |  | Fence/Guardrail        |
|  | Ground Hydrant                          |  | Fence Gate             |
|  | Trash Receptacle                        |  | Removable Bollards     |
|  | Bike Repair Station                     |  | Project Limit          |



**NYC / EDC**

QueensWay: Metropolitan Hub | Preliminary Plan (4 of 4)







**NYC / EDC**

**QueensWay: Metropolitan Hub | Perspective View - Entry Grove, Lawn, and Shade Structure**

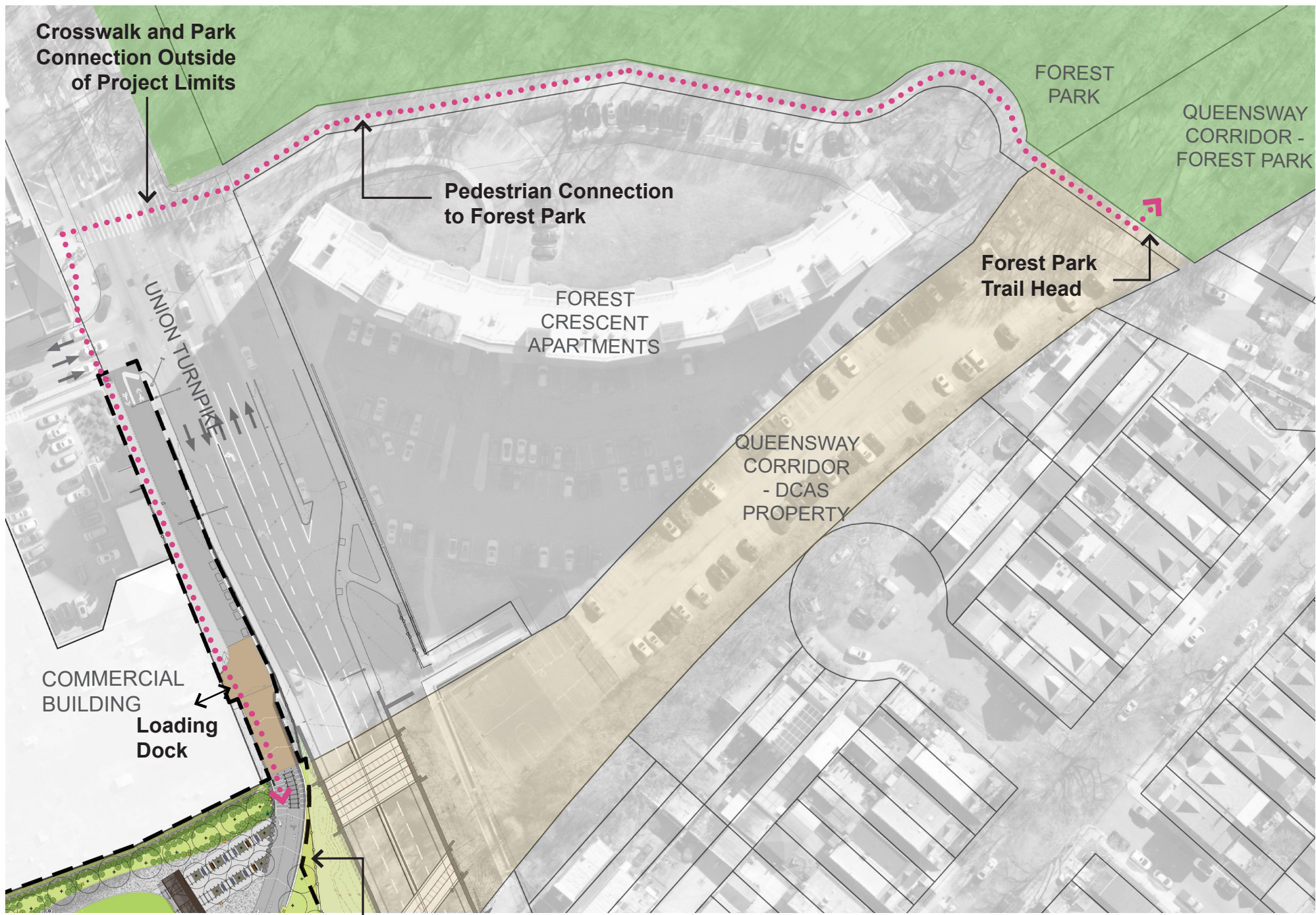

### Legend

- Asphalt
- Concrete
- Light Pole
- Signage
- Removable Bollards
- Fence/Guardrail
- Pedestrian Connection
- Project Limit
- Hexagonal Unit Paver
- Rectangular Unit Paver
- Epoxy Coating
- Existing Planting
- Proposed Planting
- Tree Pit (Mulch)
- Existing Tree
- Proposed Tree
- Proposed Shrub



**NYC / EDC**

QueensWay: Metropolitan Hub | Enlargement - Connection to Forest Park

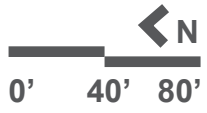

EXAMPLE OF DESIGN INTERPRETATION

DESIGN INSPIRATION

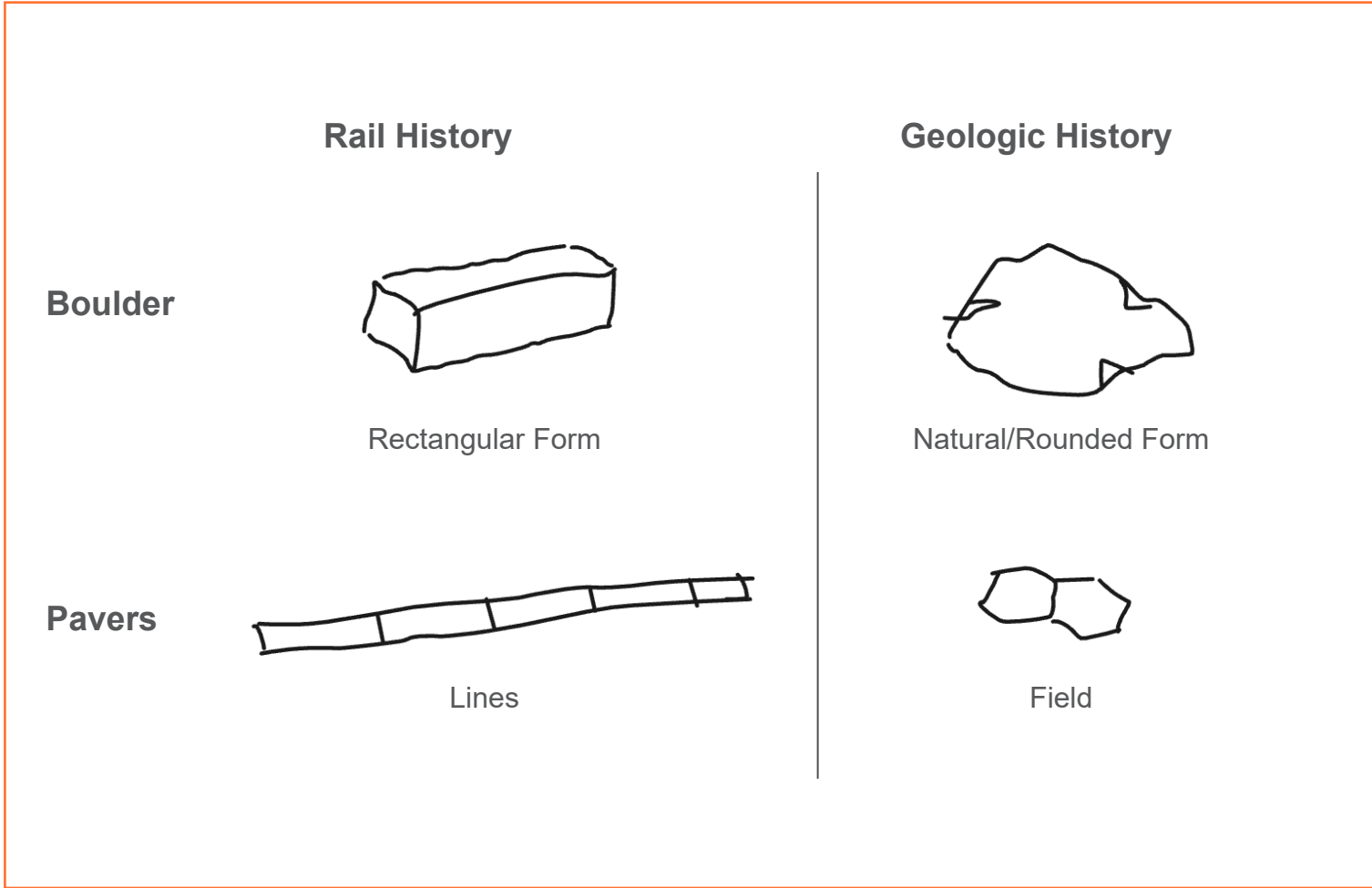

Rectangular Boulder Seating



Natural Boulder

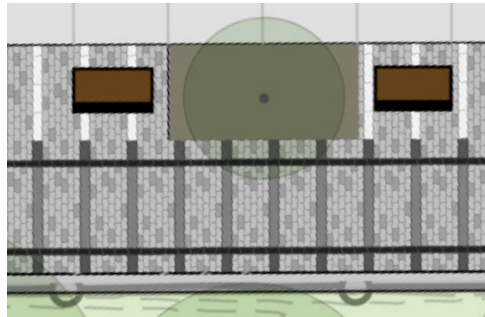

Linear Paving Pattern

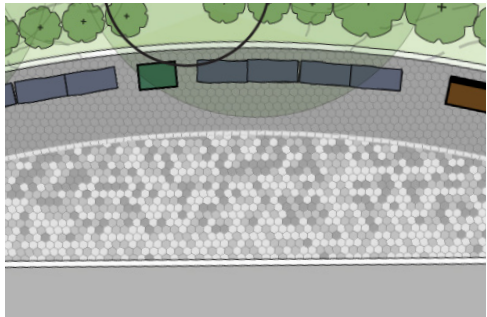

Hexagonal Paving Pattern



## DESIGN INSPIRATION

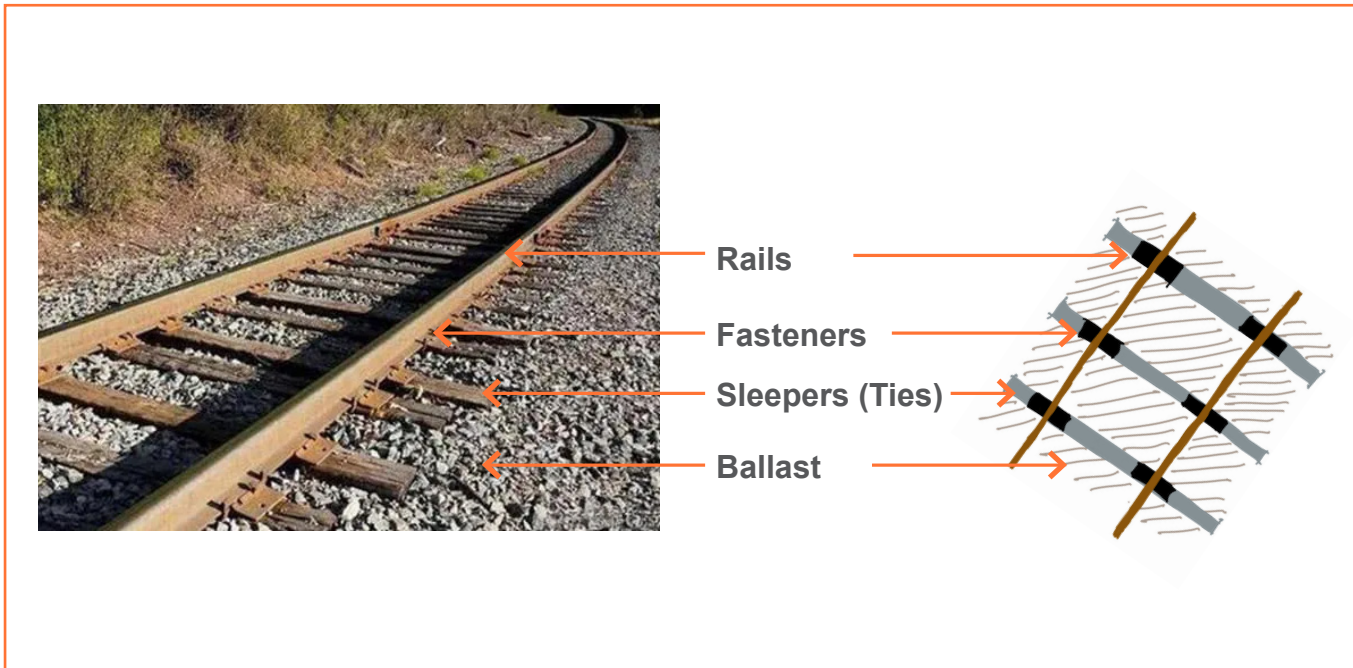

## EXAMPLE OF DESIGN INTERPRETATION

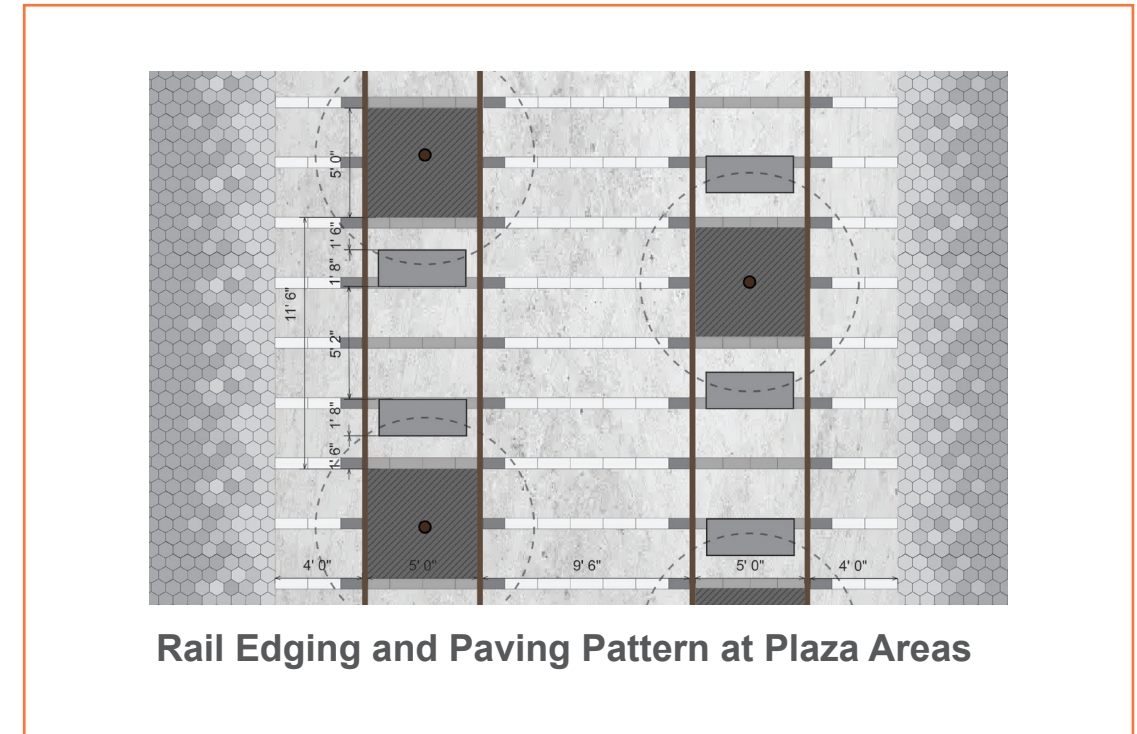

# Shade Structure as Park Identity

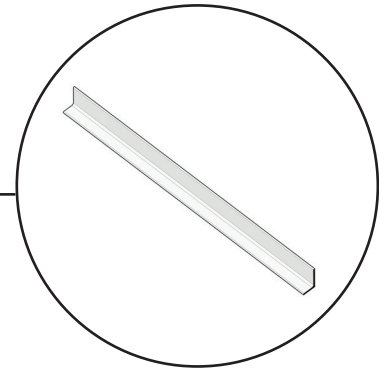

L-Angles

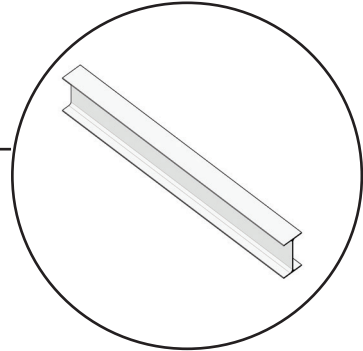

W-Shapes

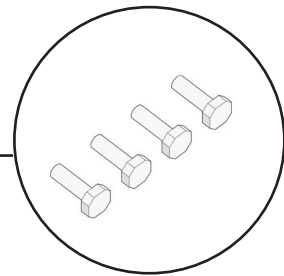

Bolted Connections

- The shade structure and signage structures pull directly from silhouettes and detailing of the historic rail line infrastructure.
- The detailing of the shade structure and signage structure prioritize ease of maintenance and longevity while celebrating its connection to the rail line infrastructure through bolted connections and expressed standard steel members.

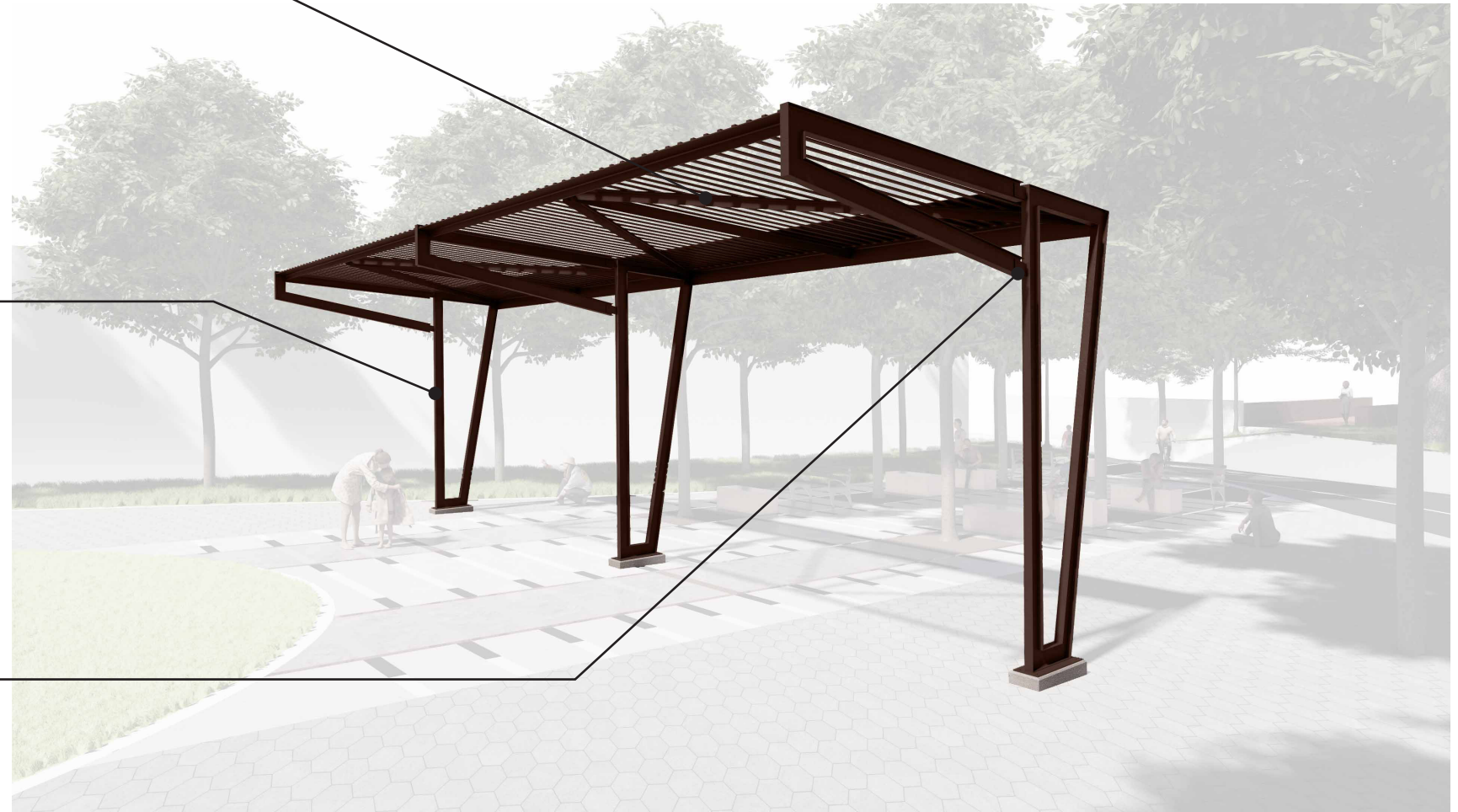

# Signage Location

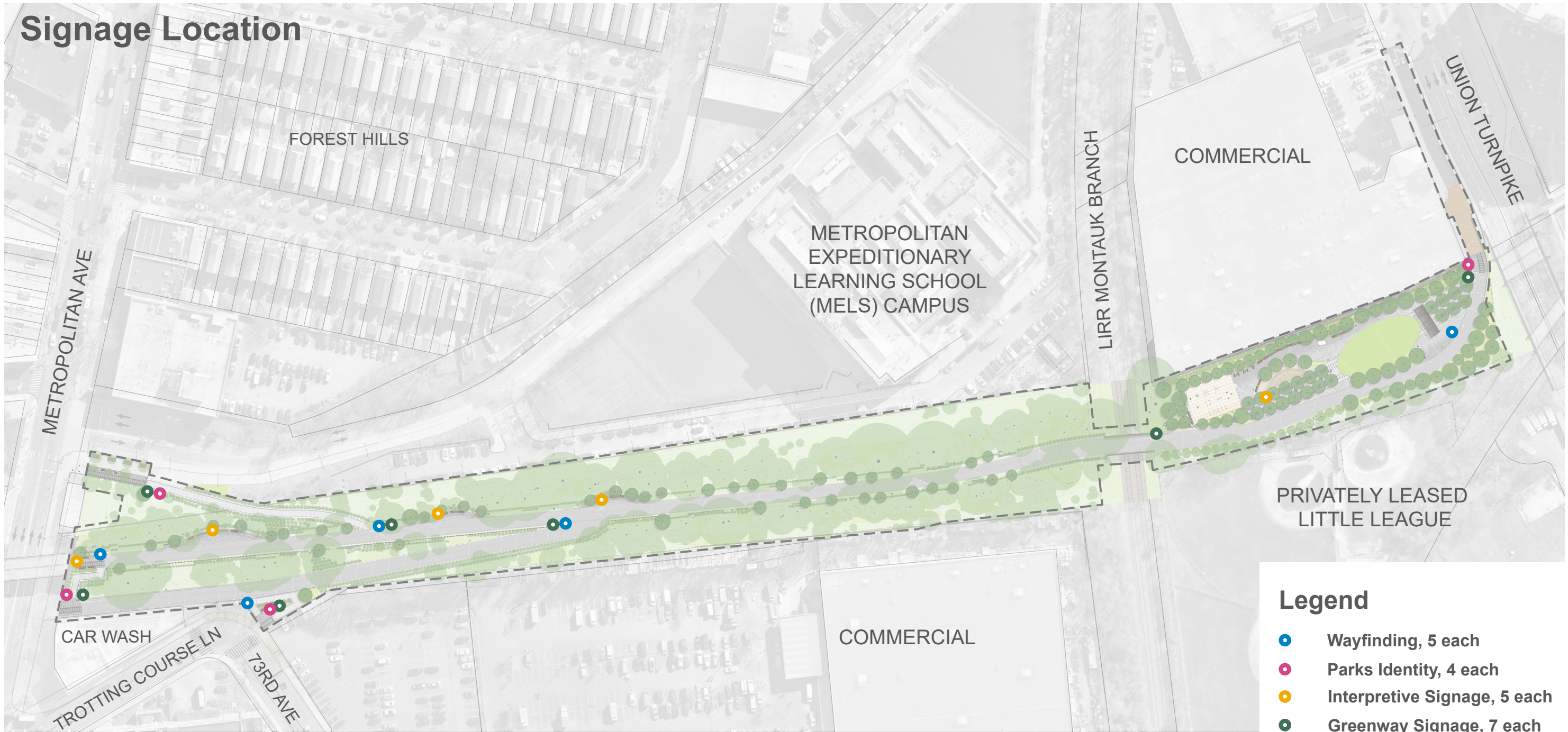

## Legend

- Wayfinding, 5 each
- Parks Identity, 4 each
- Interpretive Signage, 5 each
- Greenway Signage, 7 each



**NYC / EDC**

QueensWay: Metropolitan Hub | Proposed Signage

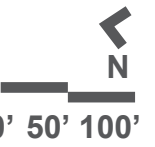

# Signage Structure Family

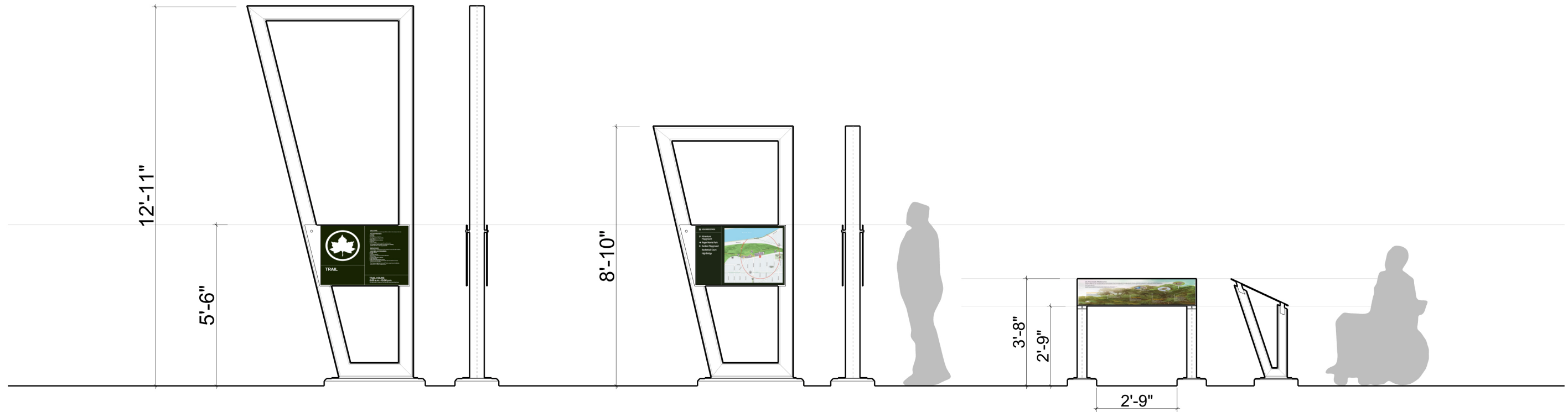

● Park Identity Signage Structure

● Wayfinding Signage Structure

● Interpretive Signage Structure

**NOTE:** All signs are NYC Parks Standard.



**NYC / EDC**

QueensWay: Metropolitan Hub | Proposed Signage

# Signage Structure Family



## ● Park Identity Signage Structure

The park identity signage structure features a large silhouette that can be seen from afar and clearly marks park thresholds. The structure's base connection prioritizes ease of maintenance, installation, and longevity.



## ● Wayfinding Signage Structure

The wayfinding signage structure is designed for pedestrians within the park and accommodates various sizes.



## ● Interpretive Signage Structure

The interpretive signage structure is ADA accessible with low height mounted signs and will be featured at key learning moments within the park.



NYC Parks

**NYC / EDC**

QueensWay: Metropolitan Hub | Proposed Signage





**NYC / EDC**

QueensWay: Metropolitan Hub | Preliminary Plan

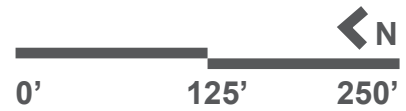

# Anticipated Project Timeline

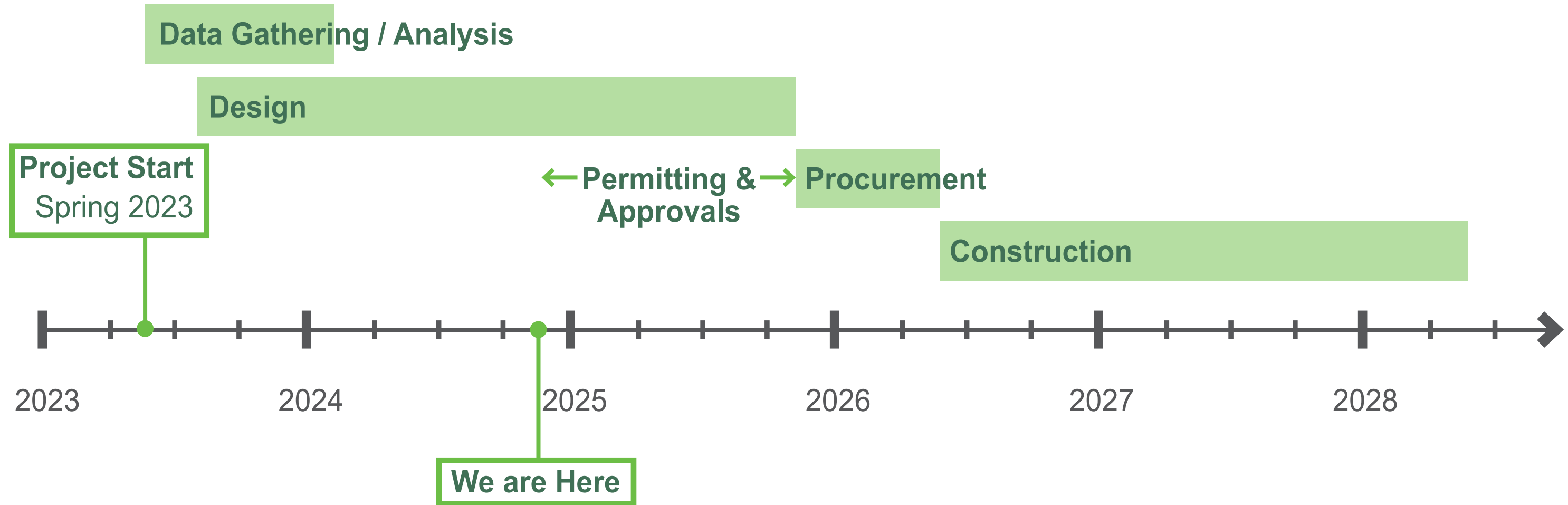

**THANK YOU!**